



Go from brilliant to breathtaking

Lighting solutions for studio, stage and TV

osram.com/entertainment

amun OSRAM

Lighting solutions for studio, stage and TV

Setting the stage for great art

Stage fright? Not any more. Our products for studio, stage and TV guarantee a smooth and dynamic lighting design – and they offer award-winning technologies. We provide the perfect supporting cast in the form of HMI®, HTI®, Lok-it!® and halogen studio lamps. Our powerful and effective lighting solutions will benefit the entertainment industry at every level, from professional film productions to small theatrical events. Prestigious awards – such as the Oscar®, the Primetime Emmy® Engineering Award and the PLASA Innovation Award – have encouraged us to maintain the highest standards in lighting for the entertainment industry. Our many years of experience, broad product range and history of innovation provide the perfect platform for continued success.



HMI® lamps for film and television were awarded in Hollywood an OSCAR® in 1987. Since 1928, and formerly under the brand OSRAM, we have been producing lamps for stage lighting, film work and cinema projection.



Acknowledging its outstanding performance and continuous improvement in technology for the TV industry, HMI® was awarded the Primetime Emmy® Engineering Award by the Academy of Television Arts & Sciences.



Light is action

HMI® – every director's darling

For almost 60 years, HMI® metal halide discharge lamps have been meeting the toughest demands of the film and TV industry. Their technology has received several awards and has become an integral part of film sets around the world.



HMI®

HMI® lamps are AC-operated metal halide discharge lamps, which have excellent color rendering and photometric integrity throughout their life.

- High intensity light simulates daylight color temperature of 6000 K with a CRI >90
- Enormous luminous flux of up to 2.3 million lm
- Very high luminous efficacy of up to 100 lm/W
- Mechanically robust with eXtreme Seal (XS) technology, up to 450°C at the pinch seal
- Capable of hot restrike ignition
- Available in wattages from 200 to 24000 W, single-ended or double-ended

Perfect light whatever the time – day or night.

With an extremely bright light, providing up to 100 lumens per watt, HMI® lamps generate a color temperature that closely matches sunlight. It reveals true colors and facilitates daytime filming outdoors. HMI® lamps are up to five times more efficient than an incandescent light.



© FR ENTERTAINMENT / B. Bauriedl



HMI® DIGITAL

Whether using analog or digital film, shooting in modes of 1000 Hz and higher, our HMI® DIGITAL line has a lamp for your production. While specially designed to accommodate evolving, high-speed film technology, HMI® DIGITAL still provides every feature needed to light traditional film productions, as well as theatre stages.

- Flicker-free when used with high-speed electronic ballasts (1000 Hz and higher)
- Suited for both analog and digital film production
- Up to 99.9 % less UV emissions (from models equipped with UV-Stop)
- Color temperature of 6000 K for realistic, naturally-lit scenes
- High color rendering index of 90+, exposing true-to-life colors
- Extremely bright light of up to 100 lumens/watt
- Hot restart capability
- Improved stability and design
- Robust stems, resulting in less breakage during transport
- Round moly-foil construction that evenly distributes heat and current, thus extending lamp life¹⁾
- Splash-proof carrying case is re-usable and allows lamps to be transported safely¹⁾

1) 6000-18000 W



HMI® packaging

Typical applications

- Film, TV and video productions
- Stage lighting (theatre, opera etc.)
- Exhibition lighting
- Lighting for major events
- Professional photography

Typical luminaires

- Follow and moving-head spotlights
- Fresnel luminaires
- PAR/open luminaires
- Soft and flood lighting

Light is excellent Studio halogen lamps

Our studio, stage and TV halogen lamps are excellent examples of the technical advances that can still be achieved in the development of lamps. The key to their success is the combination of high-quality quartz and state-of-the-art lamp technologies. The result is a powerful and economical solution for stage, film and TV lighting.



The culmination of years of experience: technical perfection

Our studio, stage and TV halogen lamps not only meet stringent requirements in terms of luminous flux, luminous efficacy and color temperature, but also through economic and durable operating demands. They are compact, heat-resistant and can be used in many operating positions. Halogen lamps are manufactured from high-quality components and feature biplanar technology. Thanks to biplanar technology, the 1000 W studio halogen lamps for example have an up to 50 % higher luminous intensity in spotlight settings.



Halogen lamps

Studio, stage and TV halogen lamps offer high luminous efficacy with low power consumption, and a relatively high proportion of visible light compared with infrared thermal radiation.

- High output from 500 to 20000 W
- High luminance
- Constant color temperature throughout their lifetime (3000-3400 K depending on type)
- Instant light
- Operation at line voltage
- Dimmable
- Eco-friendly: halogen lamps contain no mercury, i.e. no special waste disposal requirements



Pinch technology

This innovative design fixes the filament in place over the molded pinch points of the quartz bulb itself. By removing the mounting hooks and quartz bridges used in the past, the mechanical stability of the filament is improved and more resistant to vibration and shock.

- Protected against vibrations by new type of filament holder
- Very robust lamp design
- Improved durability
- Reduction of components and higher purity within the lamp
- Improvement of the halogen cycle



Typical luminaires

- PAR/open luminaires
- Fresnel lens luminaires
- Soft and flood lighting
- Follow and moving-head spotlights
- Color changers

Typical applications

- Film, TV and video productions
- Stage lighting (theatre, opera etc.)
- Exhibition lighting
- Lighting for major events
- Professional photography

Light is breathtaking HPL and Lok-it!®

Thanks to its incomparable efficiency, our halogen HPL lamp has made a name for itself on stage and in TV studios. And our halogen Lok-it!® enables users to replace lamps in no time at all.



HPL

The special filament design increases the life of the high-performance halogen lamp.

- Less maintenance with long-life versions
- Solid nickel pins for precise alignment of the lamp in the holder
- Reinforced pinch seal for extra mechanical stability
- Special metal heat sink for improved heat dissipation and optimized life

Typical luminaires

- Spotlights
- PAR luminaires
- Fresnel
- Striplights

Typical applications

- Theatre, TV, studio
- Entertainment and architecture lighting



Lok-it!®

Using a standardized bayonet design, the PGJX50, PGJX28, and PGJX36 lamp bases are easily inserted, turned, and locked into place in the corresponding lamp holders, providing for a quick lamp replacement, particularly in areas where luminaires are difficult to access.

- Studio halogen lamp 1200 W with PGJX50 base
- Standardized design
- Safe electrical and mechanical contact
- Compact form
- Robust and vibration resistant

Typical luminaires

- Follow and moving-head spotlights

Typical applications

- Theatre, TV, studio
- Entertainment and architecture lighting
- Professional photography



Ignite the show with the power of light

Lighting is utilized in concerts, shows, theaters, operas, clubs, and TV studios, resulting in a diverse demand for high-performance lamps. To meet this varied demand, our Lok-it!® Power Series family offers a comprehensive range of lamps that are precisely tailored to meet the distinct requirements of each production. These specialized lamps can be easily distinguished by their unique names, labels, and lamp bases, ensuring seamless integration and optimal performance across a wide range of applications.



A clearly defined spotlight sets the stage for a vivid concert experience with natural and brilliant lighting.



© Ralph Larmann

The right lamp for every job

In addition to the standard Lok-it!® PS, there are two other versions: Lok-it!® PS Brilliant with a CRI of 95, and Blue with an intense color temperature of 7500 K.

Name	Feature	Benefit	Key Application
Lok-it!®/PS	950 h	Stable performance and reliability	Concert lighting
Lok-it!®/PS Brilliant	CRI 95	Life-like colors and natural skin tones	Theatre lighting
Lok-it!®/PS Blue	7500 K	Bright whites for cutting through the other colors on stage	Concert lighting

The lamps can also be identified by the color on the bottom of the base making it easier than ever to choose the right lamp.



Lok-it!® PS
The standard lamps of the Lok-it!® series comes with a cutout in the base, which enables improved heat management in the moving head.



Lok-it!® PS Brilliant
When color brilliance has to be key, the Lok-it!® PS Brilliant lamps impress with lifelike colors, thanks to their high CRI of 95.

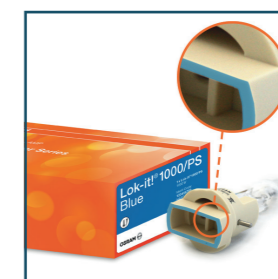

Lok-it!® PS Blue
Crisp light at the switch of a button? The Lok-it!® PS Blue delivers 7500 Kelvin light-power.

Lok-it!® Power Series:

Our Lok-it!® Power Series packs a lot of power. The lamps offer a high CRI of 90 across the range and special features, such as boosting or improved thermal resistance, the Lok-it!® Power Series has never been so powerful. Designed to give you broader versatility to meet the needs of a wide array of applications, our Power Series lamps provide top performance you can rely on.

The Lok-it!® Power Series offers:

- Natural tone of light with CRI of 90 (Brilliant: 95)
- Compact size and short arc gap for use in smaller and brighter fixtures
- Higher luminous efficiency than standard HID lamps
- Optimized filling for uniform light emission and reduced output in the green wavelengths common to HID lamps
- “Plug-and-play” base PGJX28 or PGJX36
- PGJX28 and PGJX36 ceramic bases allow a high resistance to high voltage up, to 35kV

Triple Power Effect

The Lok-it!® Power Series comes with Triple Power, identified by the symbols which appear on the outside of the box:



Power Color
New filling, as well as optimized electrodes and bulb geometry, make for a CRI as high as 95.



Power Heat
With ZrO₂ coating, eXtreme Seal (XS) Technology and additional improvements, achieving thermal re-sistance of ~500° C is now possible.



Power Boost
The improved ceramic base and burner design with an optimized filling, allows the lamp to be driven higher on demand.

© Ralph Larmann/NPO/NOS/AVROTROS

A large family with a real bite: SharXS® HTI® and SharXS® Brilliant

Thanks to their modular design, all the members of the SharXS® family are masters of creative light.

Great efficiency: short-arc technology.

The SharXS® family uses state-of-the-art HTI® technology to achieve a particularly high luminous efficacy. The arc in these light sources has been reduced to 3-10 mm. What this means for you is that the SharXS® produces a higher luminance from the same wattage and therefore saves electricity and reduces your operating costs.

Capable thermal loading: eXtreme-Seal technology.

A special coating is the key. The maximum pinch temperature is 450 °C. Because they can withstand greater thermal loads, SharXS® lamps need less cooling and are therefore quieter in operation. Thanks to the higher thermal load capacity of SharXS® lamps, less cooling is required so the luminaires are quieter in operation.

Modular design: the same dimensions for all wattages within each SharXS® family.

For luminaire manufacturers, the compact modular design means a shorter time to market and lower costs.



SharXS® packaging

SharXS® Brilliant offers:

- Natural tone of light with CRI as high as 90
- eXtreme Seal (XS) technology for improved thermal loading
- Modular design with overall length of 136 mm

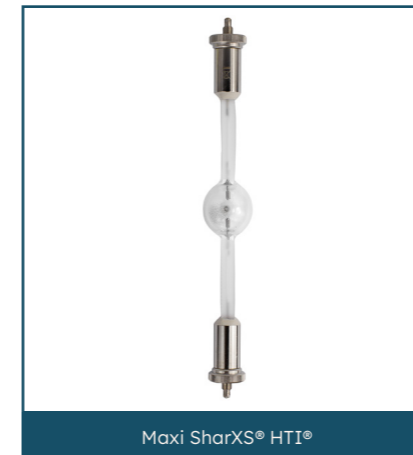

Maxi SharXS® HTI®



SharXS® HTI® and SharXS® Brilliant



Baby SharXS® HTI®

SharXS® in its element

SharXS® lamps are at home in all areas of entertainment lighting:

- Shows and events
- Clubs und discotheques
- Concert halls
- TV studios
- Advertising and retail

They are ideal for intelligent luminaires:

- Moving heads
- Scanners
- Projectors
- Color changers

Successful for decades

Double-ended lamps have enjoyed great success on the entertainment market for many years. They really play to their strengths:

- Less sensitive to heat
- Always ready for a hot restart
- Allow more compact luminaire design
- Pre-focus base for accurate lamp installation
- Double-ended lamp will allow for key-lock socket feature

SharXS® lamps are compatible with entertainment fixtures from all major manufacturers. To find an ideal match for your moving head, try our lamp replacement tool that generates a list of our entertainment lamps well-suited to your fixture and gives you the option of exploring product details.

www.osram.com/lamp-replacement-entertainment



Photo: ©Ralph Larmann/NPO/NOS/AVROTROS



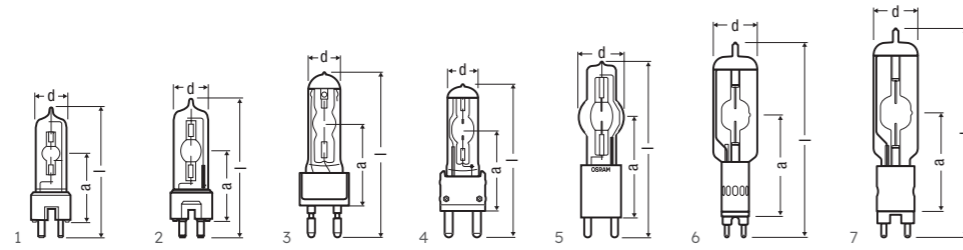

HMI® DIGITAL lamp types

Product reference	Product number	W	V	A		Im	t [h]	K		LCL a [mm]		
HMI® DIGITAL 200W	4052899984110	200	69	2.9	GZY9.5	16000	200	6900 ¹⁾	19	39	80	1
HMI® DIGITAL 400W	4052899984127	400	75	5.3	GZY9.5	32500	650	6700 ¹⁾	23	60	110	2
HMI® DIGITAL 575W	4052899984134	575	94	6.1	G22	49000	1000	6400 ¹⁾	30	70	145	3
HMI® DIGITAL 800W	4052899984141	800	95	8.4	G22	69000	1000	6300 ¹⁾	30	70	145	3
HMI® DIGITAL 1200W	4052899984196	1200	100	12	G38	110000	1000	6800 ¹⁾	40	107	200	4
HMI® DIGITAL 1600W	4062172294911	1600	155	10.3	G22	144000	750	7250 ¹⁾	40	85	173	3
HMI® DIGITAL 1800W	4052899984202	1800	140	12.9	G38	165000	750	6500 ¹⁾	40	107	200	4
HMI® DIGITAL 2500W	4052899984295	2500	118	24.5	G38	220000	500	6300 ¹⁾	60.9	127	225	5
HMI® DIGITAL 4000W	4052899984301	4000	200	24	G38	387000	500	6000 ¹⁾	75	141	250	5
HMI® DIGITAL 6000W	4062172005890	6000	123	55	GX38	600000	500	6000 ¹⁾	74	210	360	6
HMI® DIGITAL 9000W	4062172001908	9000	165	56	GX38	875000	400	6000 ¹⁾	80	210	380	6
HMI® DIGITAL 18000W	4062172123372	18000	225	88	GX51	1600000	300	6000 ¹⁾	100	260	495	7

1) Average value on electronic ballast

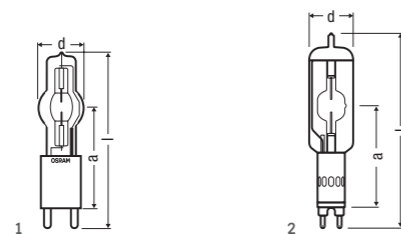

HMI®, single-ended

Product reference	Product number	W	V	A	t [h]	Im	K			LCL a [mm]				
HMI® 2500 W/SE/XS	4050300284293	2500	115	25.6	500	240000	6000	60	225	127	Any	G38	1	1
HMI® 4000 W/SE/XS	4008321244314	4000	200	24	500	380000	6000	75	250	141	Any	GX38	1	1
HMI® 12000 W/SE/XS	4050300650418	12000	160	84	500	1150000	6000	100	455	260	Other	GX38	1	2

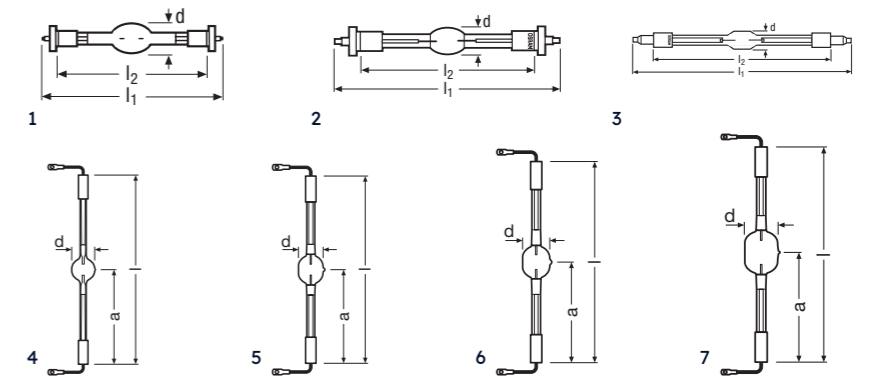

HMI®, double-ended

Product reference	Product number	W	V	A	t [h]	Im	K							
HMI® 575 W/DXS	4008321285102	575	95	7	1000	49000	6000	21	135	115	Any	SFc10-4	1	1
HMI® 1200 W/DXS	4008321931153	1200	100	13.8	1000	110000	6000	27	220	180	Any	SFc15.5	1	2
HMI® 2500 W/S XS	4050300025780	2500	115	25.6	500	240000	6000	31.5	210	150	Other	SFa21-12	1	3
HMI® 2500 W/DXS	4008321182197	2500	115	25.6	500	240000	6000	31.5	355	290	Other	SFa21	1	3
HMI® 4000 W/DXS	4008321210203	4000	200	24	500	380000	6000	36	405	340	p15	SFa21	1	3
HMI® 4000 W/DXS SOLAR	4052899152601	4000	201	24	500	395000	7000	36	405	340	p15	SFa21-12	1	3
HMI® 6000 W/DXS	4008321210210	6000	122	55	500	570000	6000	54	450	-	p15	S25.5	1	4
HMI® 12000 W/DXS	4008321210227	12000	240	84	500	1150000	6000	64	470	-	p15	S30	1	5
HMI® 18000 W/DXS	4008321370280	18000	380	79	500	1700000	6000	70	500	-	p15	S30	1	6
HMI® 24000 W/DXS	4008321355805	24000	280	86	500	2300000	6000	83	1000	-	p15	S30	1	7

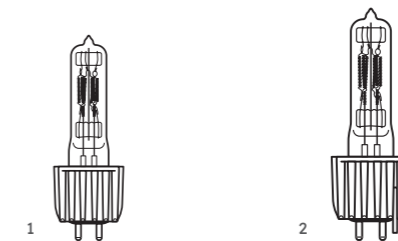

HPL lamp types

Product reference	Product number	W	V	A	t [h]	Im	K						
HPL 93728 575 W	4050300461816	575	230	400	13165	3200	19	98	104	Any	G9.5 w/Hsink	1	1
HPL 93728 575 W	4050300461830	575	240	400	13280	3200	19	98	104	Any	G9.5 w/Hsink	1	1
HPL 93728 LL 575 W	4008321090102	575	230	1500	10365	3050	19	98	104	Any	G9.5 w/Hsink	1	1
HPL 93728 LL 575 W	4008321174444	575	240	1500	11745	3050	19	98	104	Any	G9.5 w/Hsink	1	1
HPL 93729 750 W	4050300654201	750	230	300	17885	3200	19	104	104	Any	G9.5 w/Hsink	1	2
HPL 93729 750 W	4052899246898	750	240	300	16895	3200	19	104	104	Any	2 pins	1	2
HPL 93729 LL 750 W	4052899246881	750	230	1500	15595	3050	19	104	104	Any	G9.5 w/Hsink	1	2
HPL 93729 LL 750 W	4052899246911	750	240	1500	13960	3050	19	104	104	Any	2 pins	1	2



To access the energy label and product information sheet please visit our electronic product catalogue https://www.osram.com/ecat/Halogen%20lamps-Entertainment-Specialty%20Lighting/com/en/GPS01_3169907/

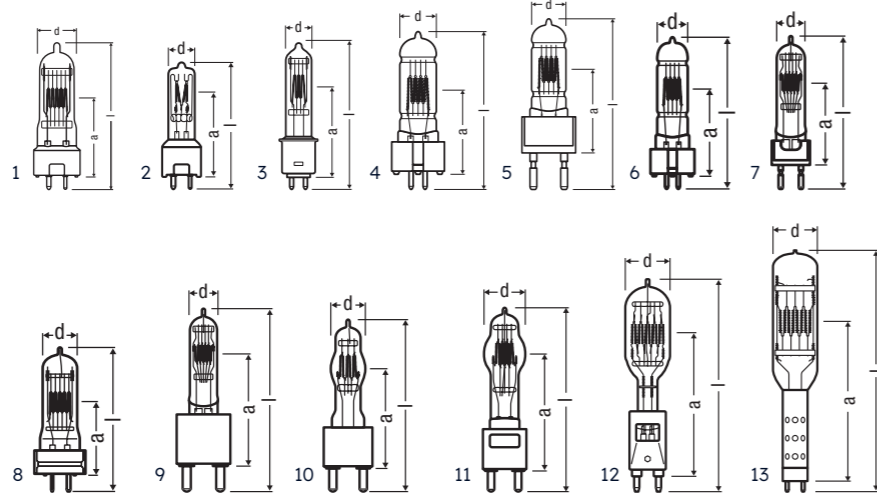

Halogen studio lamps

Product reference	Product number	ANSI	LIF	W	V	t _[h]	K	Ø [mm]	l [mm]	LCL a [mm]	Icons	Icons	Icons	Icons
64673	4052899015463	FSL	CP/81	300	230	200	3100	18	80	46.5	Any	GY9.5	12	2
64673	4052899015487	FSK	CP/81	300	240	200	3100	18	90	46.5	Any	GY9.5	12	2
64670	4008321624017	GCV	T/25	500	230	300	3000	23	90	46.5	s90	GY9.5	12	1
64670	4008321624031	GCV	T/25	500	240	300	3000	23	90	46.5	s90	GY9.5	12	1
64674	4052899015500	FRH	CP/82	500	230	200	3200	18	90	46.5	Any	GY9.5	12	2
64674	4052899015524	FRJ	CP/82	500	240	200	3200	18	90	46.5	Any	GY9.5	12	2
64680	4008321098573		A1/244	500	230	50	3200	22	74.9	36.5	Any	GY9.5	12	1
64680	4008321098597		A1/244	500	240	50	3200	22	74.9	36.5	Any	GY9.5	12	1
64716	4008321623973	GKV		600	230	250	3050	19	101	60.5	s90	G9.5	12	3
64716	4008321623997	GKV		600	240	250	3050	19	101	60.5	s90	G9.5	12	3
64717	4008321624215	FRL	CP/89	650	230	150	3200	23	90	46.5	s90	GY9.5	12	1
64717	4008321624239	FRM	CP/89	650	240	150	3200	23	90	46.5	s90	GY9.5	12	1
64718	4008321624253	GCT	T/27	650	230	400	3000	23	90	46.5	s90	GY9.5	12	1
64718	4008321624277	GCT	T/27	650	240	400	3000	23	90	46.5	s90	GY9.5	12	1
64719	4008321638076		T/12	650	230	750	3000	26	110	55	s90	GX9.5	20	4
64720	4008321638090		CP/23	650	230	100	3200	26	110	55	s90	GX9.5	20	4
64721	4008321638113	FKH	CP/39	650	230	100	3200	26	140	63.5	s90	G22	20	5
64678	4008321624055			800	230	250	3200	19	101	60.5	s90	G9.5	12	3
64752	4008321624475	FWS	T/29	1200	230	400	3000	27	125	67	s90	GX9.5	20	6
64752	4008321624499	FWS	T/29	1200	240	400	3000	27	125	67	s90	GX9.5	20	6
64754	4008321624529	CP/90	1200	230	200	3200	27	125	67	s90	GX9.5	20	6	
64756	4008321624550	CP/93	1200	230	200	3200	26	140	63.5	s90	G22	20	5	
93723	4008321370594	CP/110	1200	80	300	3200	25.4	120.7	63.5	Other	G22	12	7	
64777	4008321632197	CP/92	2000	230	400	3200	35	175	90	s90	G22	12	7	
64787	4008321653994	CP/75	2000	230	400	3200	35	160	75	s90	G22	12	7	
64788	4008321632173	FTM	CP/72	2000	230	400	3200	35	145	70	s90	GY16	12	8
64788	4008321632180	FTM	CP/72	2000	240	400	3200	35	145	70	s90	GY16	12	8
64789	4008321654021	FKK	CP/73	2000	230	400	3200	35	210	127	s90	G38	6	9
64789	4008321654038	FKK	CP/73	2000	240	400	3200	35	210	127	s90	G38	6	9
64796	4008321653987	CP/91	2500	230	400	3200	35	175	90	s90	G22	12	7	
64797	4052899129542			3000	230	400	3200	45	210	127	s90	G38	6	10
64805	4052899129566	CP/85	5000	230	400	3200	60	279	165	s90	G38	6	11	
64805	4052899129573	CP/85	5000	240	400	3200	61	279	165	s90	G38	6	11	
64815	4050300780696	CP/83	10000	230	350	3200	80	380	254	Other	G38	6	12	
64818	4008321792051	CP/99	20000	230	350	3200	100	550	354	Other	G38	4	13	

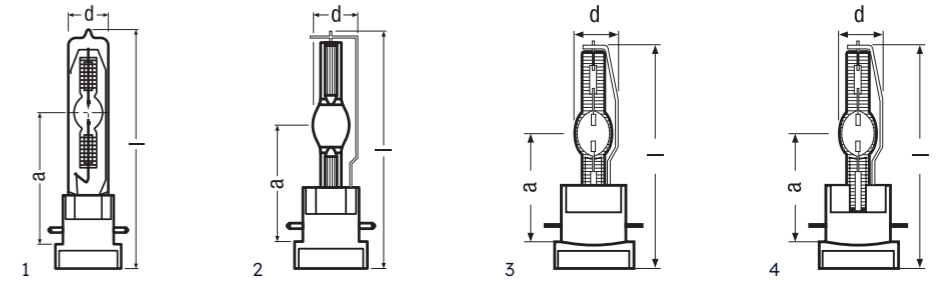

Lok-it! lamp types

Product Name	Product Number	W	V	A	t _[h]	lm
Lok-it! metal halide lamp						
Lok-it! HSD 300W/80/P28	4008321644831	300	95	3.2	2000	20500
Lok-it! HTI 400W/60/P28	4008321605481	400	67	6.2	750	30000
Lok-it! HTI 700W/60/P50	4062172398909	700	60	11.7	750	49000
Lok-it! HTI 700W/60/P28	4052899179790	700	60	11.6	750	50000
Lok-it! HTI 700W/75/P50	4008321485205	700	68	10.3	750	50000
Lok-it! HTI 700W/75/P28	4008321510549	700	68	10.3	750	50000
Lok-it! HTI 1500W/60/P50	4008321553416	1500	100	15	750	130000
Lok-it! HTI 1500W/60/P50 M3W	4008321818997	1500	100	15	750	130000
Lok-it! HTI 1600W/60/P50	4062172123488	1600	83.3	19.2	750	140000
Lok-it! HTI 2000 W/60/P50	4062172133098	2000	107	18.6	750	165000
Lok-it! HTI 2000 W/75/P50	4062172133111	2000	100	20	750	155000

Lok-it! Power Series

Lok-it! 1000/PS	4052899965157	1000	85	8	750	85000
Lok-it! 1000/PS Brilliant	4052899965164	1000	85	11.8	750	82000
Lok-it! 1400/PS Brilliant	4052899965195	1400	95.5	14.7	750	118000
Lok-it! 1700/PS	4052899965201	1700	84.5	20	750	135000
Lok-it! 1800/PS Brilliant	4062172047081	1800	88	20.5	750	148000
Lok-it! 2000/PS Brilliant	4062172169561	2000	108	18.6	1000	165000

Product Name	K	Ra	Ø [mm]	l [mm]	LCL a [mm]	Icons	Icons	Icons
Lok-it! metal halide lamp								
Lok-it! HSD 300W/80/P28	8700	> 70	23	122.3	67	5	PGJX28	1
Lok-it! HTI 400W/60/P28	6500	> 80	23	103	56	3.4	PGJX28	2
Lok-it! HTI 700W/60/P50	5800	75	25	125	65	4.1	PGJX50	3
Lok-it! HTI 700W/60/P28	5800	> 70	18	112	56	4.1	PGJX28	2
Lok-it! HTI 700W/75/P50	7250	> 75	25	125	65	4	PGJX50	3
Lok-it! HTI 700W/75/P28	6700	> 75	23	112	56	4	PGJX28	2
Lok-it! HTI 1500W/60/P50	6000	> 85	29	128	65	6.1	PGJX50	3
Lok-it! HTI 1500W/60/P50 M3W	6000	> 85	29	130	67	7	PGJX50	3
Lok-it! HTI 1600W/60/P50	6000	95	26	125	65	5.5	PGJX50	3
Lok-it! HTI 2000 W/60/P50	6000	95	29	130	67	7	PGJX50	3
Lok-it! HTI 2000 W/75/P50	7500	77	29	130	67	7	PGJX50	3

Lok-it! Power Series

Lok-it! 1000/PS	6000	> 80	28	112.5	56	5.5	PGJX36	4
Lok-it! 1000/PS Brilliant	6000	95	28	112.5	56	5.5	PGJX36	4
Lok-it! 1400/PS Brilliant	6000	> 93	28	120	60	5.3	PGJX28	4
Lok-it! 1700/PS	6000	> 92	28	121	60	5.2	PGJX28	4
Lok-it! 1800/PS Brilliant	6000	> 92	28.5	121	60	5.2	PGJX28	4
Lok-it! 2000/PS Brilliant	6000	95	28.5	121	60	7	PGJX28	4



Technical data

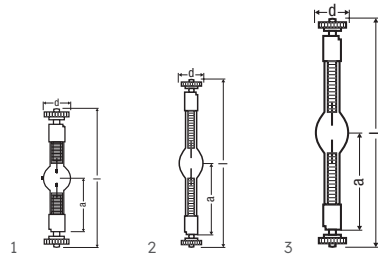

SharXS® HTI® lamp types

Product reference	Product number	W	V	kV START	A	t _h	lm	K
Baby SharXS® HTI®								
Baby SharXS HTI 250 W/D5/80	4008321129161	250 ¹⁾	95	2.0/20 ²⁾	3.3	3000	19000	8000
Baby SharXS HTI 300 W/D5/57	4008321129185	300 ¹⁾	75	4.5/20	4.3	3000	20000	5700
Baby SharXS HTI 300 W/D5/65	4008321129208	300 ¹⁾	95	4.5/20	3.6	750	22000	6500
Baby SharXS HTI 575 W/D5/56	4008321129345	575 ¹⁾	93	4.5/20	7.2	500	43000	5600

SharXS® HTI® and SharXS® Brilliant								
SharXS HTI 400 W/D3/75	4008321285157	400 ¹⁾	50	3.0/25 ²⁾	8.5	750	26000	7500
SharXS HTI 700 W/D4/60 ³⁾	4008321285218	700 ¹⁾	70	3.0/25 ²⁾	11	750	59000	6000
SharXS HTI 700 W/D4/75	4008321285232	700 ¹⁾	70	3.0/25 ²⁾	10	750	59000	7500
SharXS HTI 1200 W/D7/60	4008321285256	1200 ¹⁾	96.6	5.0/35	12.4	750	110000	6900
SharXS HTI 1200 W/D7/75 ³⁾	4008321285270	1200 ¹⁾	95.3	5.0/35	12.6	750	91000	8800
SharXS HTI 1500 W/D7/60 ⁴⁾	4008321349569	1500 ¹⁾	110	5.0/35	13.6	750	145000	6000
SharXS 1200 W Brilliant	4052899562622	1200 ¹⁾	90	5.0/35	13.3	750	110000	6100
SharXS 1500 W Brilliant	4052899561793	1500 ¹⁾	110	5.0/35	13.6	750	132000	6200

Maxi SharXS® HTI®								
Maxi SharXS HTI 1800 W/D10/60	4062172399807	1800 ¹⁾	107	-	17	750	160000	6500
Maxi SharXS HTI 2000 W/D10/60	4008321334947	2000 ¹⁾	105	-	19.0	750	200000	6000

	R _a	∅ d [mm]	l [mm]	LCL a [mm]				No.
Baby SharXS® HTI®								
Baby SharXS HTI 250 W/D5/80	>85	16	93	35	5.0	Any	SFfc10-4	1 1
Baby SharXS HTI 300 W/D5/57	80	16	93	35	5.0	Any	SFfc10-4	1 1
Baby SharXS HTI 300 W/D5/65	85	16	93	35	5.0	Any	SFfc10-4	1 1
Baby SharXS HTI 575 W/D5/56	85	16	93	35	5.0	Any	SFfc11-4	1 1

SharXS® HTI® and SharXS® Brilliant								
SharXS HTI 400 W/D3/75	80	18	136	57.5	3.0	Any	SFfc10-4	1 2
SharXS HTI 700 W/D4/60 ³⁾	>80	18	136	57.5	4.0	Any	SFfc10-4	1 2
SharXS HTI 700 W/D4/75	>80	21	136	57.5	4.0	Any	SFfc10-4	1 2
SharXS HTI 1200 W/D7/60	85	21	136	57.5	7.0	Any	SFfc10-4	1 2
SharXS HTI 1200 W/D7/75 ³⁾	80	21	136	57.5	7.0	Any	SFfc10-4	1 2
SharXS HTI 1500 W/D7/60 ⁴⁾	>80	24.5	136	57.5	7.0	Any	SFfc10-4	1 2
SharXS 1200 W Brilliant	94	21	136	57.5	7.6	Any	SFfc10-4	1 2
SharXS 1500 W Brilliant	93	24.5	136	57.5	7.0	Any	SFfc10-4	1 2

Maxi SharXS® HTI®								
Maxi SharXS HTI 1800 W/D10/60	90	30.5	220	90	10.0	Any	SFfc15.5	1 3
Maxi SharXS HTI 2000 W/D10/60	>90	28	220	90	10.0	Any	SFfc15.5	1 3

ams OSRAM Group
ams-osram.com

1) Not relevant | 2) Cold / Hot | 3) XS = eXtreme Seal (maximum permissible foil temperature 450 °C) | 4) May be operated from 1,200...1,500 W

OSRAM GmbH
Marcel-Breuer-Strasse 4
80807 Munich, Germany
Phone +49 89-6213-0
Fax +49 89-6213-2020
www.osram.com

